

Project General Information:

Project Name: Example 6 - 9801 San Francisco Road NE

Address: 9801 San Francisco Road NE

Contractor Name: Company 1

Contractor Phone: 505.XXX.XXXX

Developer Name: Company 2

Developer Phone: 505.XXX.XXXX

Designer Name: Company 3

Designer Phone: 505.XXX.XXXX

Availability Statement/Serviceability Letter #: NA

Project Summary:

| Description | Quantity Installed | Fee Amount Per Item Installed | Survey Required |
|-----------------------|--------------------|-------------------------------|-----------------|
| 1-inch Water Service | 1 | \$50 | No |
| 4-inch Sewer Services | 1 | \$50 | No |

Total Fee Amount: \$ 100

Entities affected by this work (indicate all that apply):

- Bernalillo County
 Village of Los Ranchos
 AMAFCA
 City of Albuquerque
 NMDOT
 MRGCD
 Other _____

Utility Development Approvals:

Utility Development Approval for Construction: _____

Utility Development Approval for Records: _____

Put together by Utility Development

Close Out Instructions:

At the conclusion of the construction process a “Close Out Package” is required. The following items shall be included in the Close Out Package:

- Compaction results. (Specification in General Notes)
- Itemized final invoice for public water and sewer infrastructure installed.
- A copy of the “Approved Products Materials List”, with all utilized products highlighted, and with any deviations noted. The location of the “Approved Products Materials List” can be found within the “Info For Builders” tab on the Water Authority home page.
- As-built information with location information as specified in the General Conditions
- Any recording information pertaining to easements that may have been required for new or existing on-site public infrastructure.
- WUA Inspector Contact Information: David Sedillo | 505.917.2904
- Cross Connections approved backflow preventer to be installed Yes.

Water Authority Inspections Required:

| Req'd | Inspector Approval | Contact Information |
|-------------------------------------|--------------------|---|
| <input type="checkbox"/> | | WUA Cross Connections Inspection Required. 505.289.3465, 505.289.3454 |
| <input type="checkbox"/> | | For salvage of removed large meter infrastructure. 505.289.3547 |
| <input type="checkbox"/> | | For inspection of vacuum pit installation. 505.289.3428 |
| <input type="checkbox"/> | | For salvage of all removed vacuum sewer infrastructure. 505.289.3428 |
| <input type="checkbox"/> | | For inspection of pretreatment devices (such as a grease interceptor or amalgam separator). 505.289.3439 |
| <input type="checkbox"/> | | Inspection of large meter vault installation. 505.289.3547 or 505.289.3585 |
| <input checked="" type="checkbox"/> | | WUA Inspector Final Approval. (See contact above) |

* Utility Development Section will get these approvals via email. These written approvals are meant to support the contractor in coordination with these different sections.

Inspection Requirement Notes:

- A minimum 24-hour notification is required for all inspections.
- The contractor shall coordinate with the Water Authority seven (7) days in advance of performing work that will affect the public water or sanitary sewer infrastructure. Work requiring shutoff of well collectors, transmission lines, or facilities designated as Master Plan Facilities must be coordinated with the Water Authority fourteen (14) days in advance of performing such work.
- Only Water Authority crews are authorized to operate public valves.

Put together by Utility Development

Permit Valid Until: 10/6/2022



Sanitary Sewer Connections/Installations:

- Construction will take place on what type of system:
 - **Gravity**

Gravity Sewer

- New service connection as per DWG No. 2125.

Water Connections/Installations:

- Connections to the water system shall adhere to DWG No. 2301.

Water service (2" or smaller)

- Installation of $\frac{3}{4}$ " or 1" services shall be installed as per DWG No. 2361, 2362, 2366, and 2368.

Put together by Utility Development

General Conditions:

The following General Conditions are provided for all Connection Permits:

- All public infrastructure shall be located via either or both of the following:
 - Surveyed GPS Coordinates apply to all items listed in the “Project Summary” Section:
 - GPS coordinates from a Professional Surveyor licensed in the State of New Mexico are required.
 - The survey data shall include X, Y, and Z coordinates.
 - The horizontal datum shall be NAD 1983 NM State Plan Central Zone, and NAVD 1988 for vertical datum.
 - Valves shall be measured at the valve operating nut.
 - Hydrants shall be measured at the valve flange.
 - Manholes shall be taken at the center of the cover and at the pipe inverts.
 - Meter vaults require X, Y, and Z coordinates at the following locations:
 - Center of the vault.
 - Each public valve associated with the service
 - All other features may be located by survey as described above, or as follows:
 - Indicate distance/length from a known permanent point or feature.
 - Permanent existing features include: Property Corner rods, existing manhole centers, existing Water Authority Valves,
 - Accuracy shall be within five (5) feet.
- Connections to the water system where the connecting main size diameter is equal to 2/3 (or greater) the size of the existing public main shall be a non-pressure connection (TEE connection).
 - Example:
 - Connecting line size = 6”, existing public main size = 8”
 - $(2/3) \times 8" = 5.33"$, 6” is greater than 5.33”, therefore the connection is a non-pressure connection.
 - This note is not applicable to public hydrants which are always non-pressure connections.
- Concrete tests results – Reference “Section 101 Portland Cement Concrete”
 - Ensure that correct concrete mix is used.
- Density test results – Reference “Section 700 Trenching and Boring for Utilities” – City Standards and Specifications
 - Ensure that the correct densities adjacent to installed infrastructure is observed.

Put together by Utility Development

Permit Valid Until: 10/6/2022

Shut-off valves 602 and 271

Valve 602

Valve 271

Put together by Utility Development

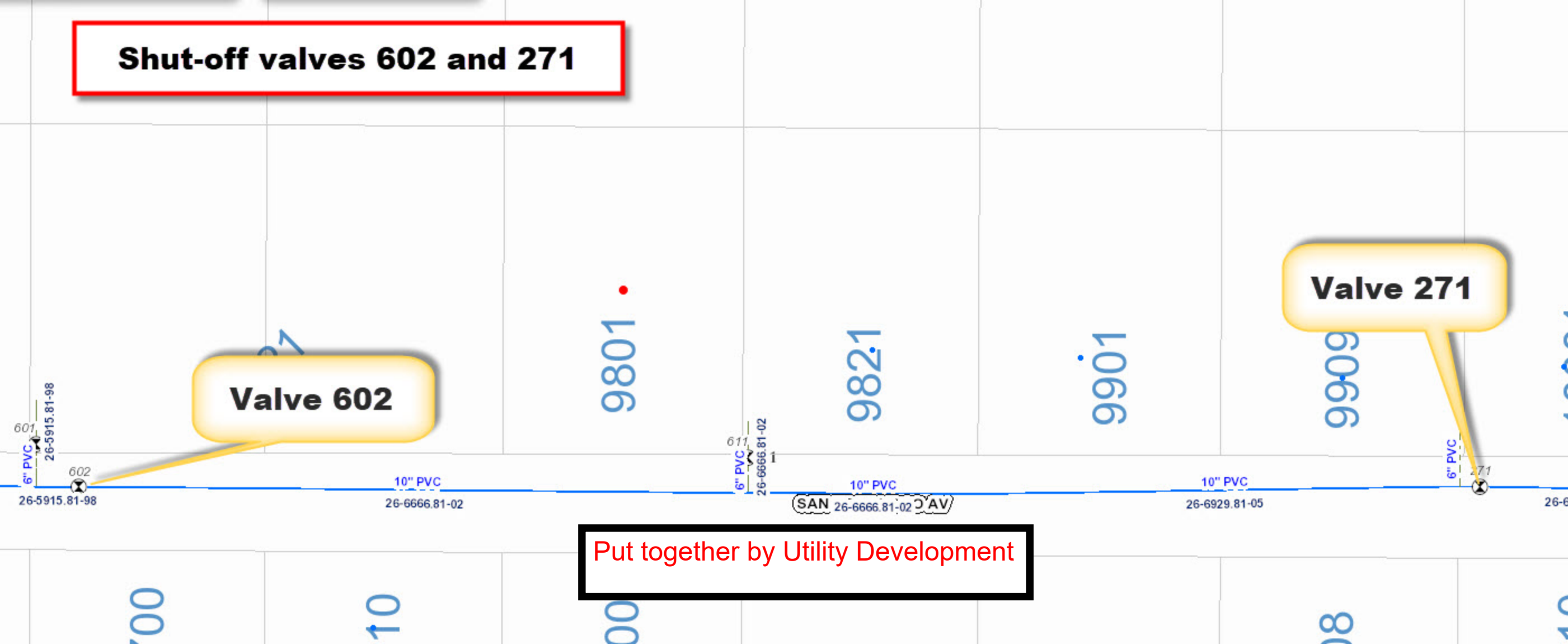



General Notes:
Install 3/4-inch meter
Install 4-inch sewer service



9121

9801

9821

9901

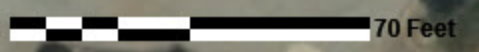
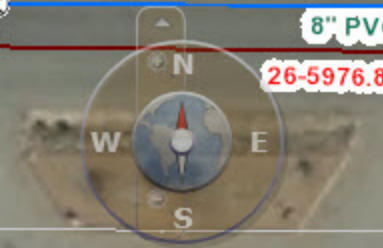

8" PVC
26-5976.81-99

D21501

10" PVC
26-6666.81-02

8" PVC
26-5976.81-99

SAN FR

D21511

10" PVC
26-6666.81-02

8" PVC
26-5976.81-99

10" PVC
26-6929.81-05

6" PVC
26-6666.81-02

93

Submitted in the on-line request by the designer